

**Single Ended - Grounded Shield  
Weldable**

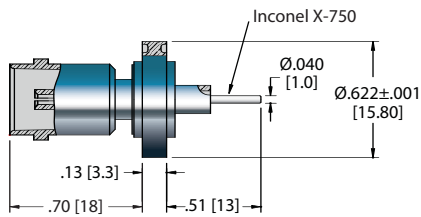

**ISO KF**

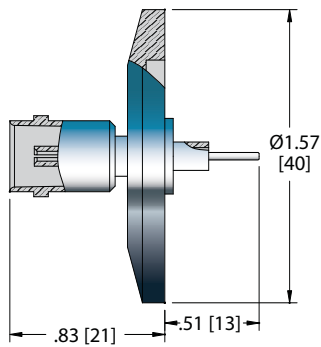

**ConFlat**

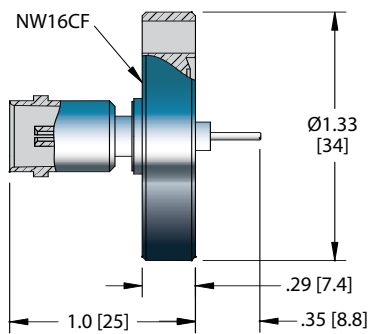

**Double Ended - Grounded Shield  
Weldable**

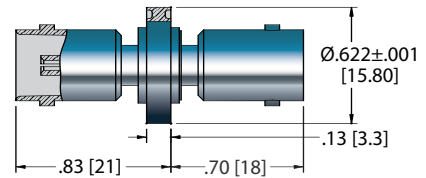

**ISO KF**

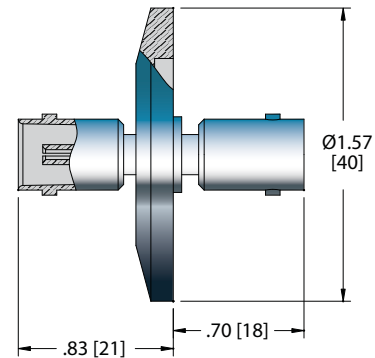

**ConFlat**

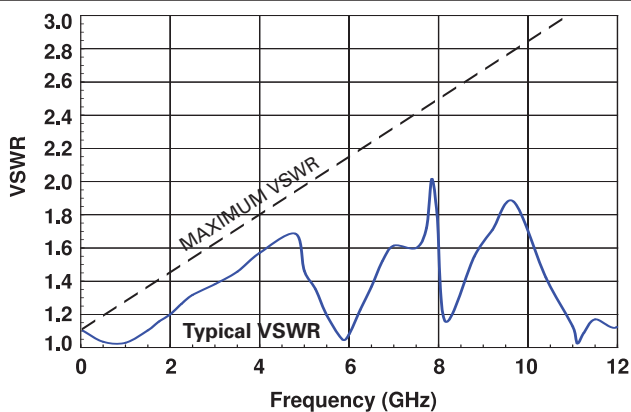
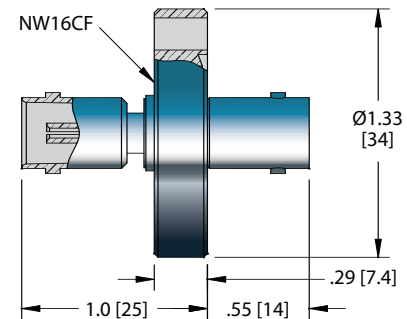

**Specifications**

**Materials**

- Housing: 304 Stainless steel
- Pin: Inconel X-750
- Insulation: Glass-ceramic
- Magnetic Materials: No

**Voltage Rating** 500 V DC

**Current Rating** 1 Amp

**Temperature Range** -269°C to 350°C, ISO KF -25°C to 205°C

**Pressure @ 20°C** 1400 PSIG (97 Bar), ISO KF 0 PSIG



Single & Double Ended Weldable



STYLE	INSTALLATION	PART NUMBER
Single Ended	Weld	21200-01-W
Double Ended	Weld	21201-01-W

ISO FLANGE

Single & Double Ended ISO KF



Single Ended	NW25KF	21205-01-KF
Double Ended	NW25KF	21207-01-KF

CONFLAT FLANGE

Single & Double Ended ConFlat



Single Ended	1 1/3" ConFlat (NW16CF)	21204-01-CF
Double Ended	1 1/3" ConFlat (NW16CF)	21206-01-CF

Air Side Plug



TYPE	VOLTAGE DC	CONDUCTOR AMPS	DIMENSIONS		DESCRIPTION	PART NUMBER
			H	L		
Air Side	500 V	5	0.56 [14]	1.1 [28]	BNC Plug	7116-02

Air Side Cable Assembly



TYPE	LENGTH	VOLTAGE DC	CONDUCTOR AMPS	TEMPERATURE		PART NUMBER
				MIN	MAX	
50 Ohm BNC – Double Ended	10'	500 V	5	-40	85	18921-01-A

Contacts



TYPE	MATERIAL	DESCRIPTION	PART NUMBER
Crimp Type Contacts	Copper Alloy - Gold Flash	Accepts wire up to 0.040 [1.0]	16167-03-A
Crimp Tool		For 0.025" – 0.075" Diameters	2840-05

\*Contacts priced and sold in packages of 5. See the Accessories section for more information on all accessories.

COAXIAL